



# Cornering Options

INSTALLATION GUIDE

**THERMORY**<sup>®</sup>  
LEAVE A LASTING IMPACT

Please find the following drawings as options of corner detailing for your upcoming Thermory project. These drawings are by no means a conclusive list, but are meant to inspire the many options at your disposal.

- ▶ Interior and Exterior details can be mixed and matched and can be also carried over to our Pine and Spruce cladding options as well.
- ▶ As a rule all fasteners must be stainless, whether it be screws, brads or nails. We also carry matching plugs if you desire to hide the fastening.
- ▶ Please allow for a gap of at least 1/32" for expansion and do not caulk the gap.





# OPTION 1 – 1 x 4 No Groove Decking Utilized

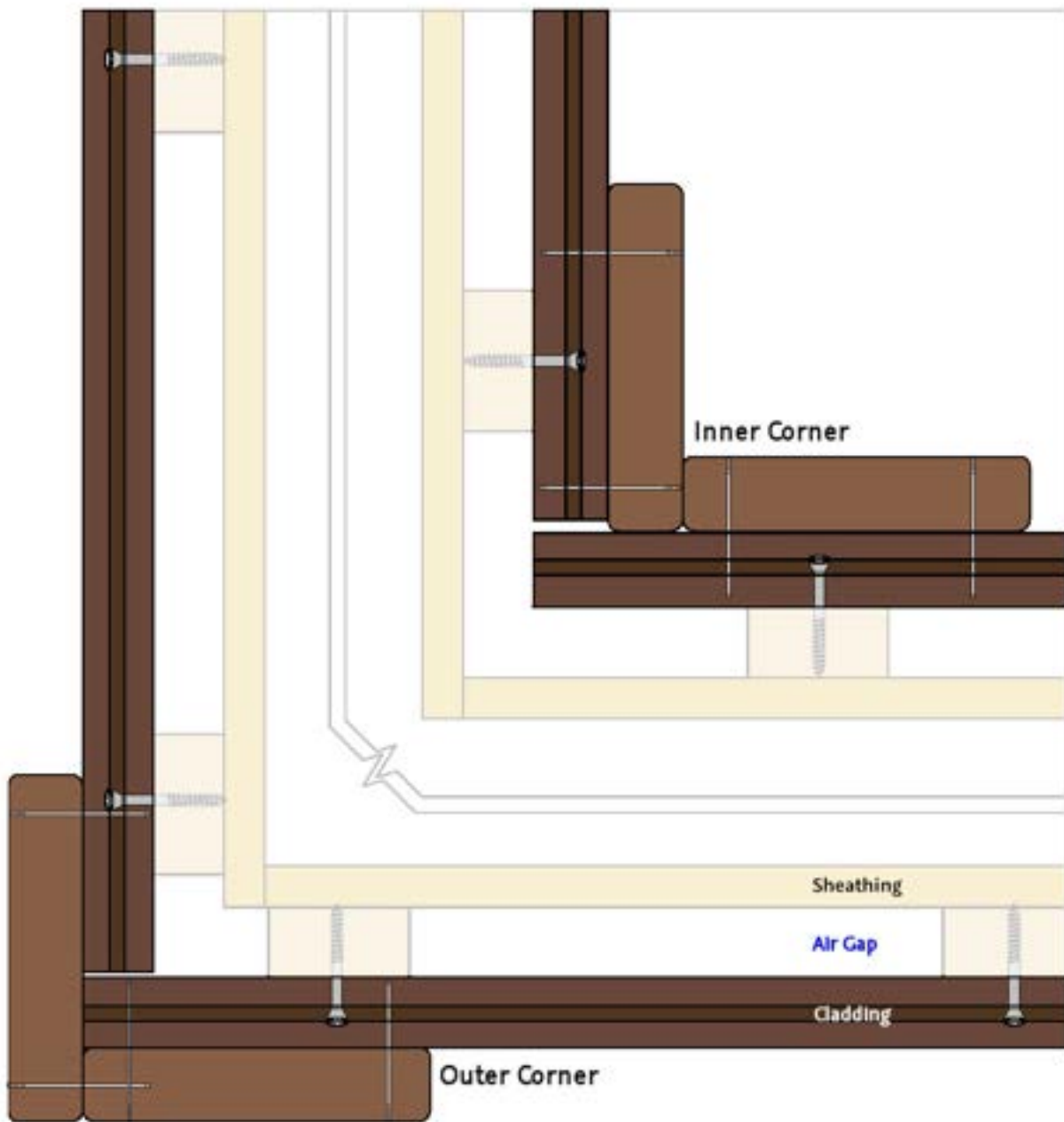



# OPTION 2 – Butting with 5/4 and 2 X Material

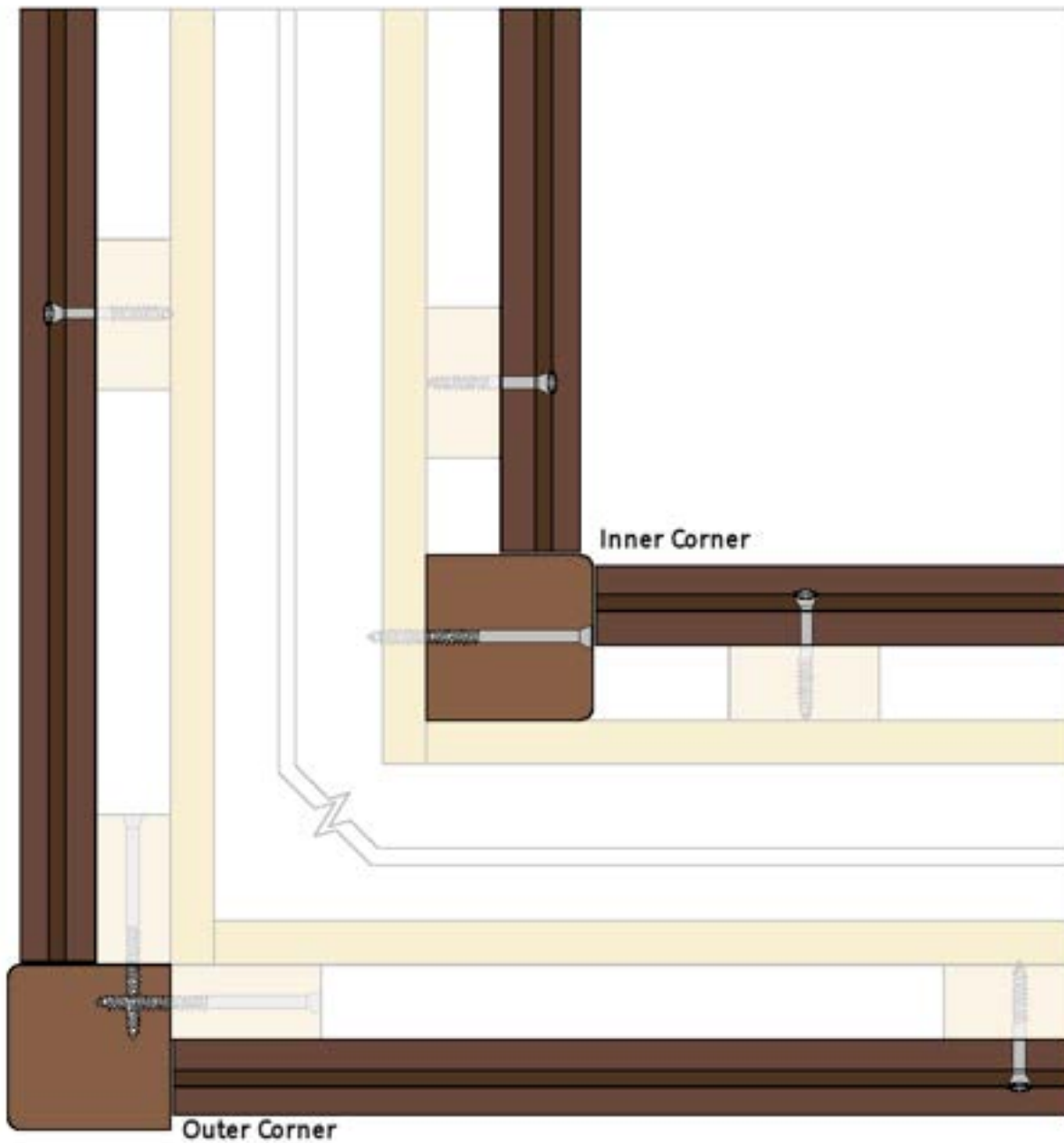



# OPTION 3 – Mitered Corner with Slight Gap

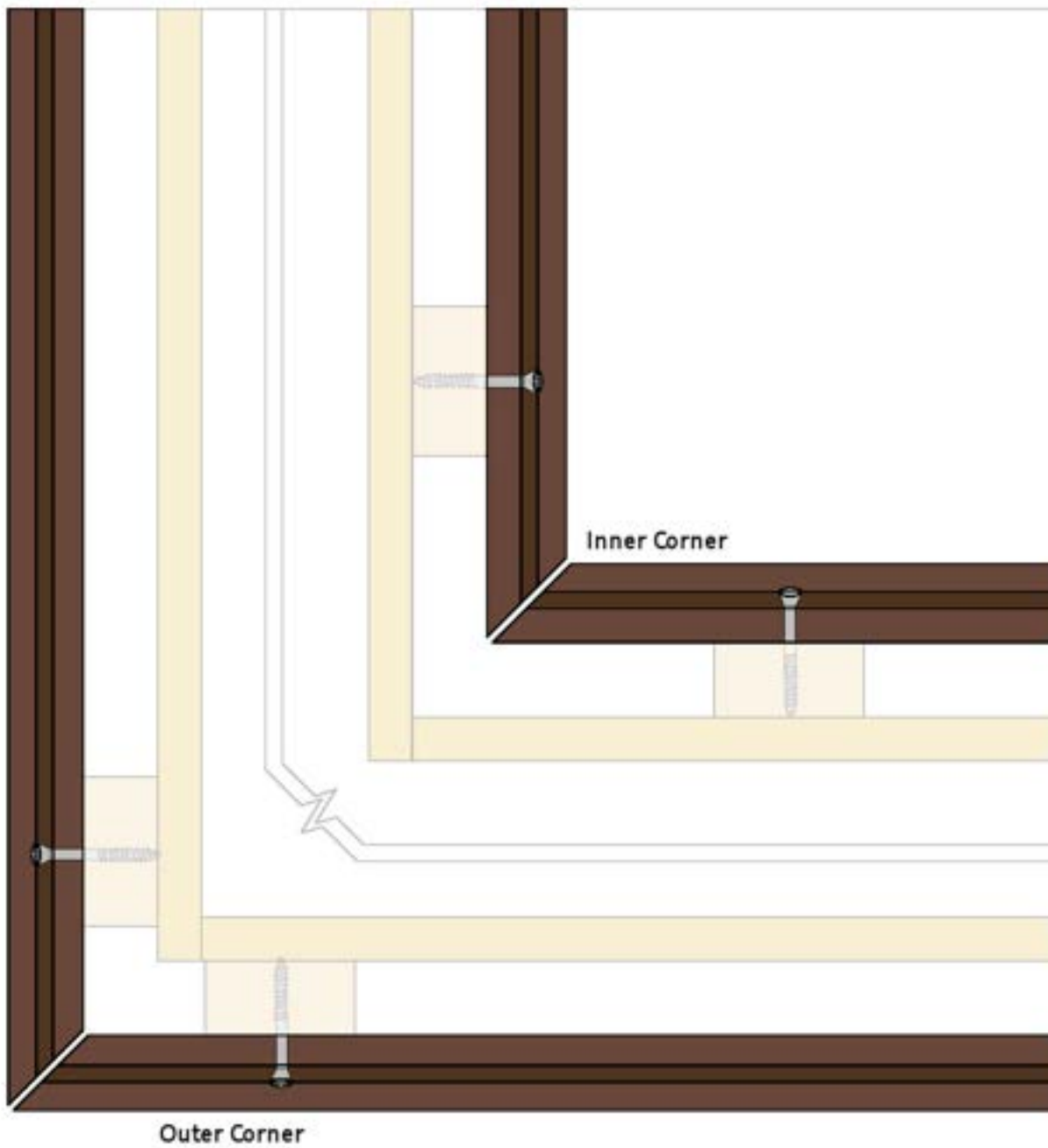

# OPTION 4 – Capped Corners

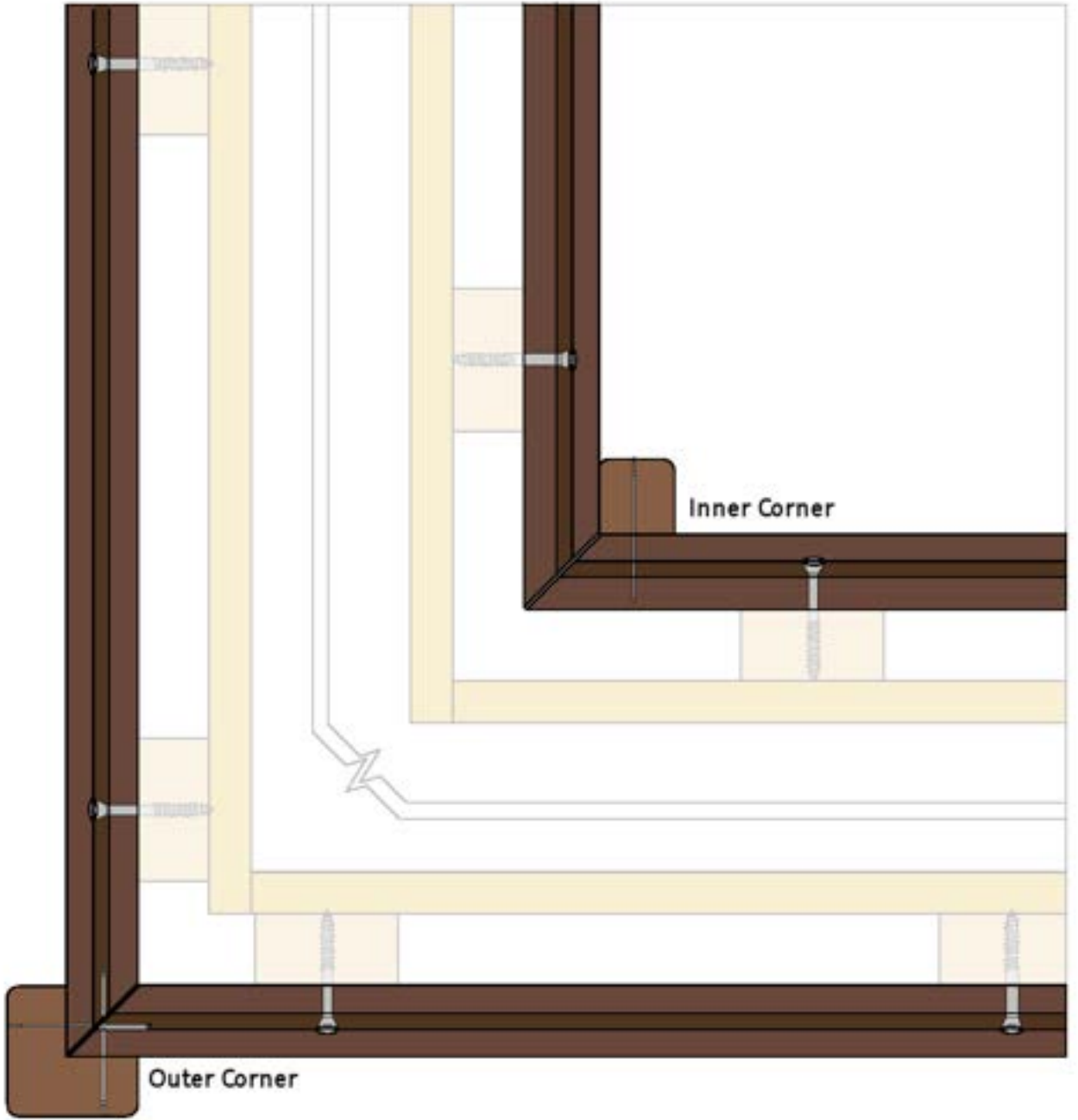



# OPTION 5 – 5/4 x 4 Decking for Corners

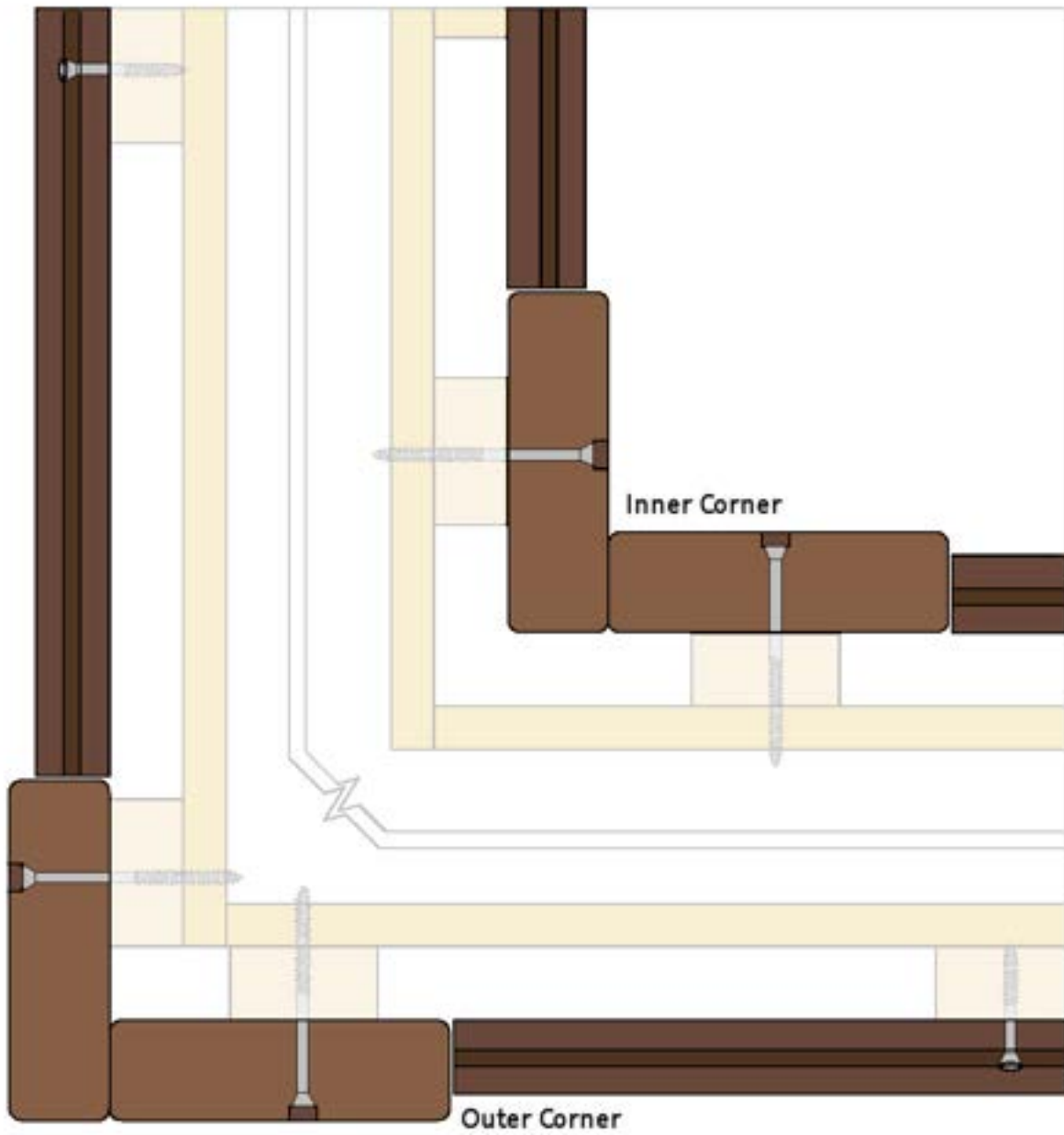

# OPTION 6 – EasyTrim Inside & Outside Corner

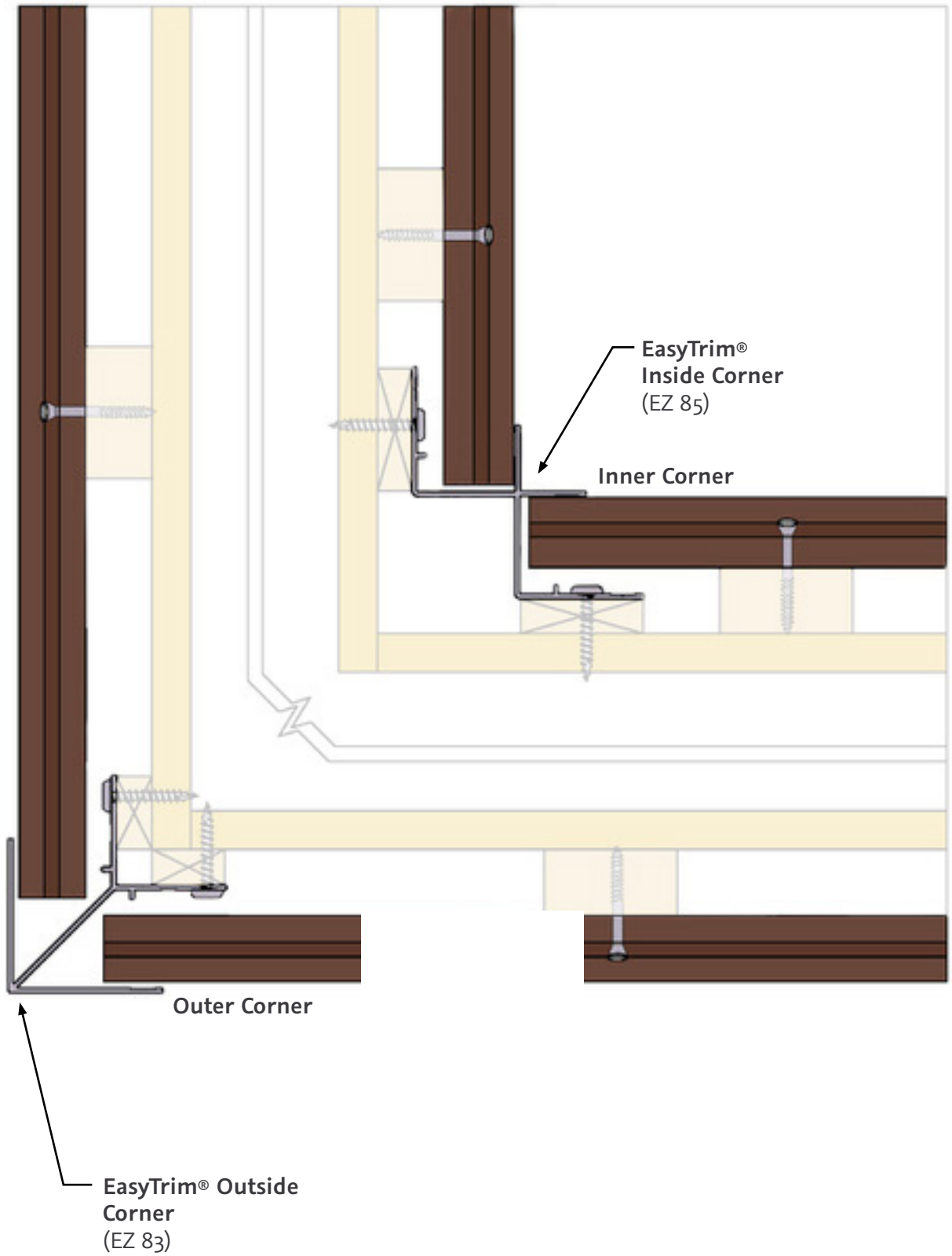



# OPTION 7 – EasyTrim Inside & Outside Corner

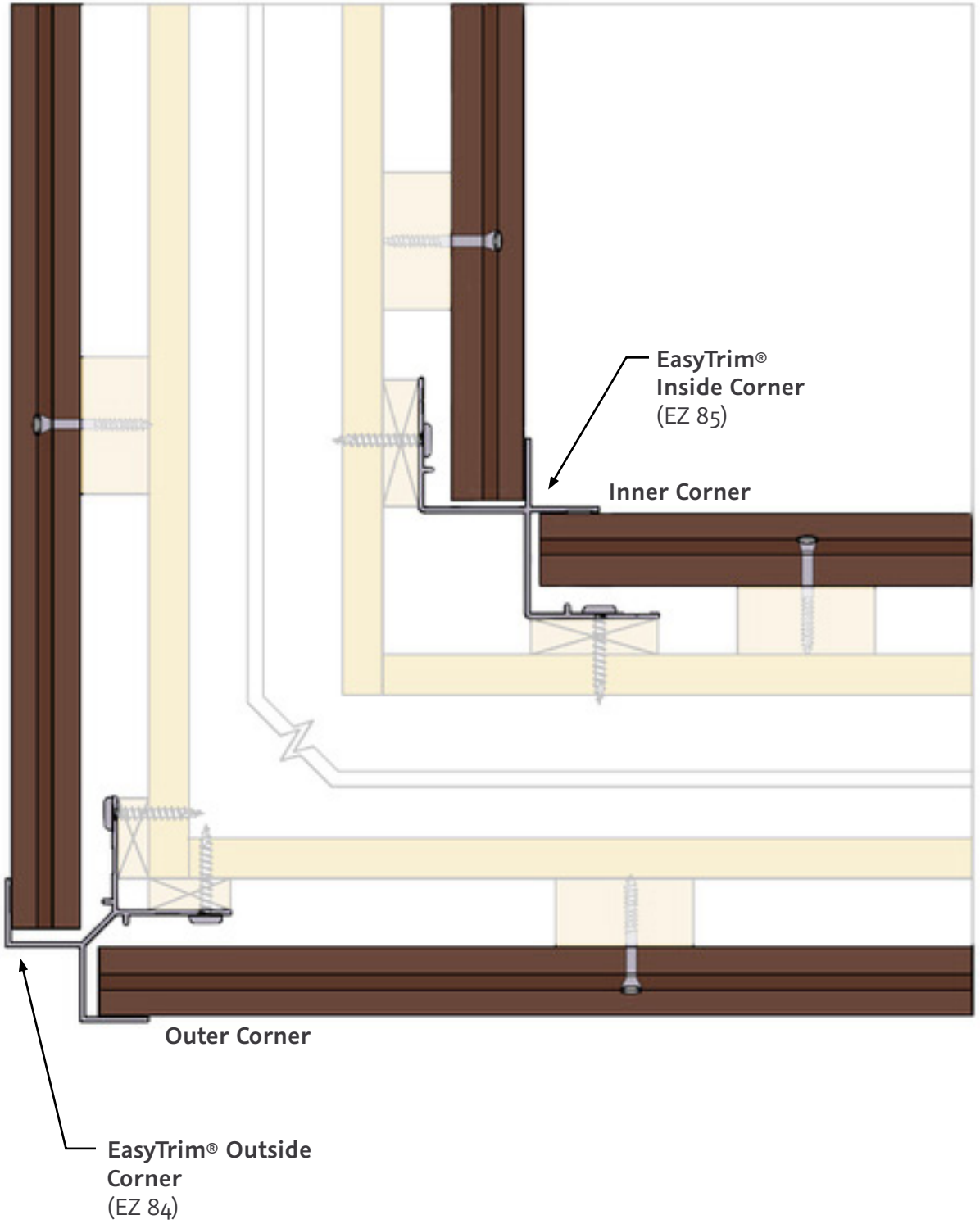

# OPTION 8 – Aluminum Outside and Inside Corners

